

TRAMPILLON CON ARQUETA
E= 1:10

Cotas en mm.

CUELLO REGISTRO

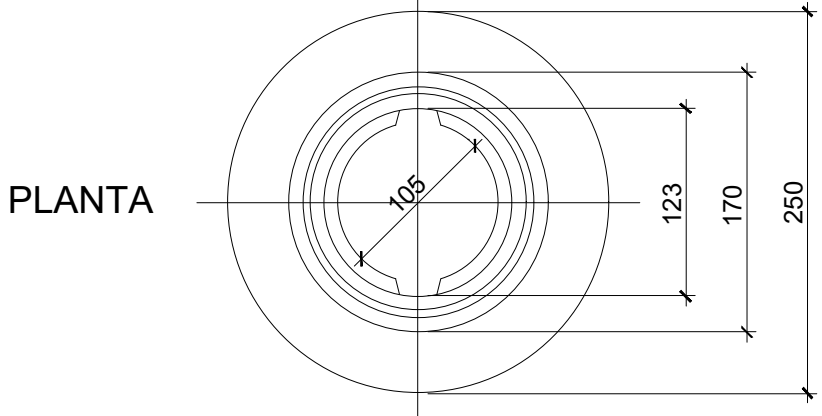

SECCION

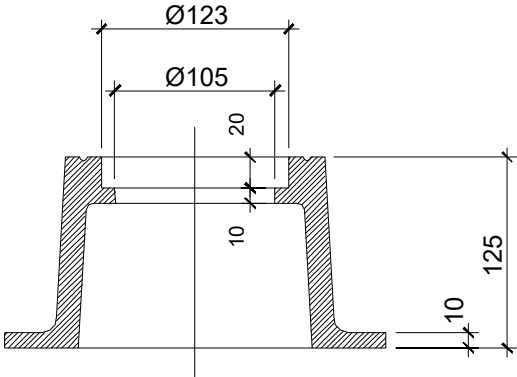

TAPE

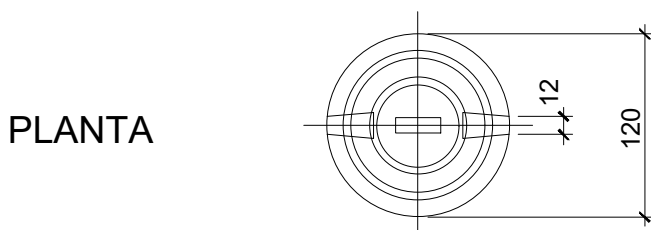

SECCION

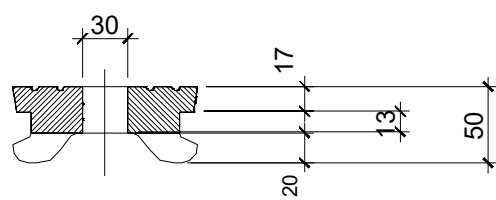

NORMA EN-124
CALIDAD EN-1563
MATERIAL EN-GJS-500-7

PESO > 11 Kgs.

TRAMPILLON SIN ARQUETA
E= 1:10

Cotas en mm.

PLANTA

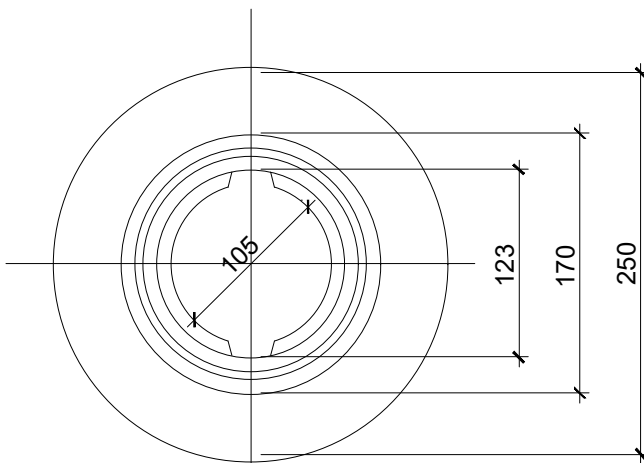

SECCION

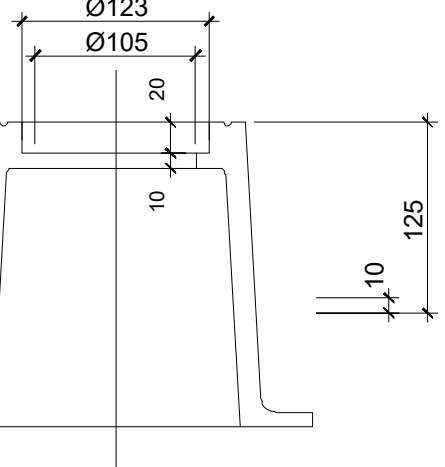

TAPE

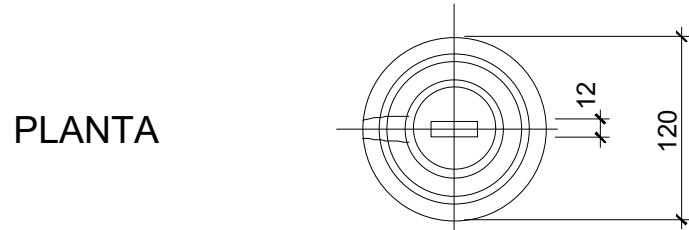

SECCION

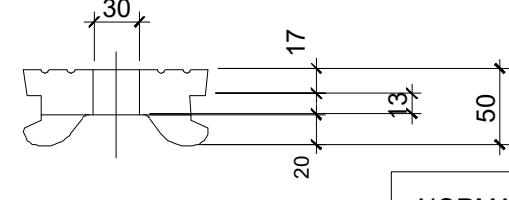

NORMA EN-124
CALIDAD EN-1563
MATERIAL EN-GJS-500-7

TRAMPILLON EN ACERAS H=< 1,20 m
(CON TUBO DE PVC)
E= 1:20

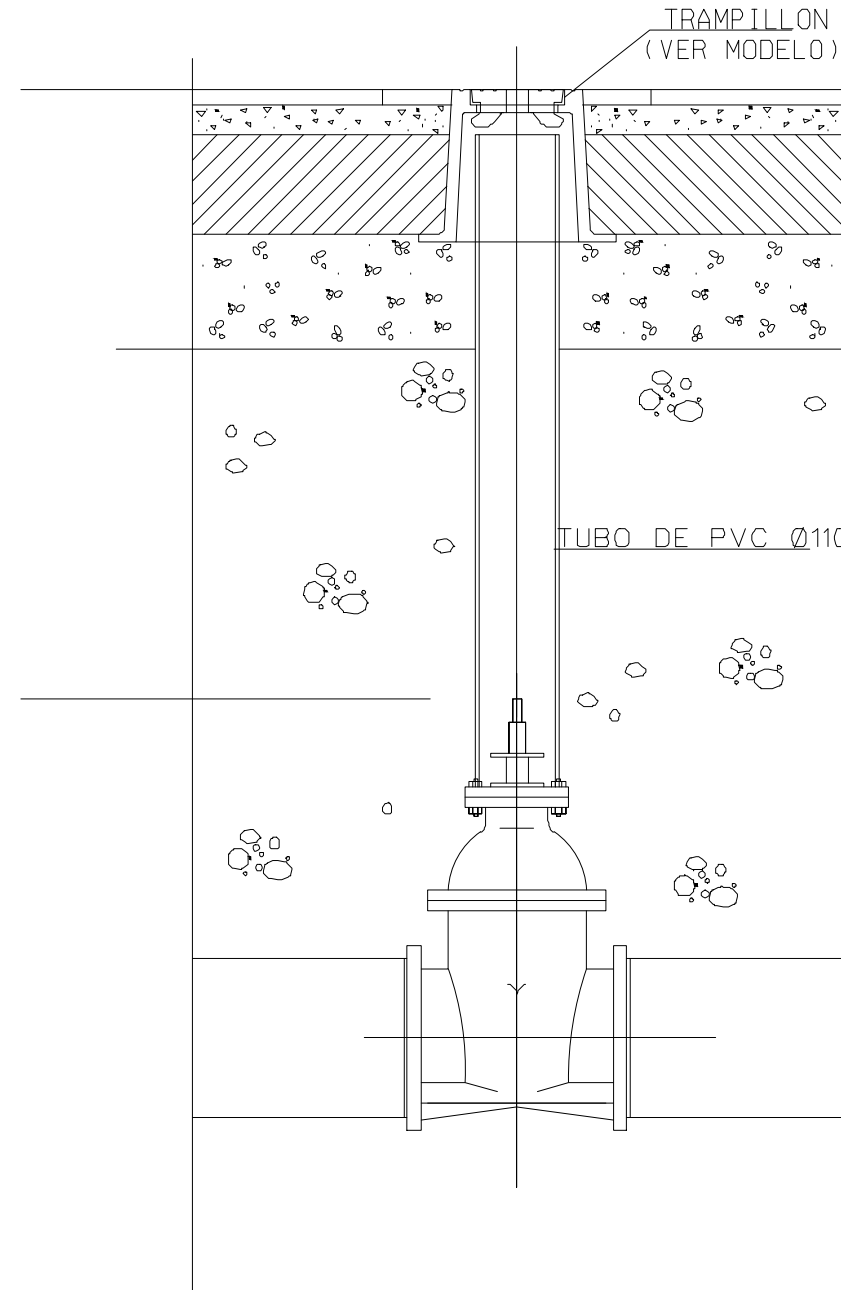

TRAMPILLON EN CALZADA H=< 1,20 m
(CON TUBO DE PVC)
E= 1:20

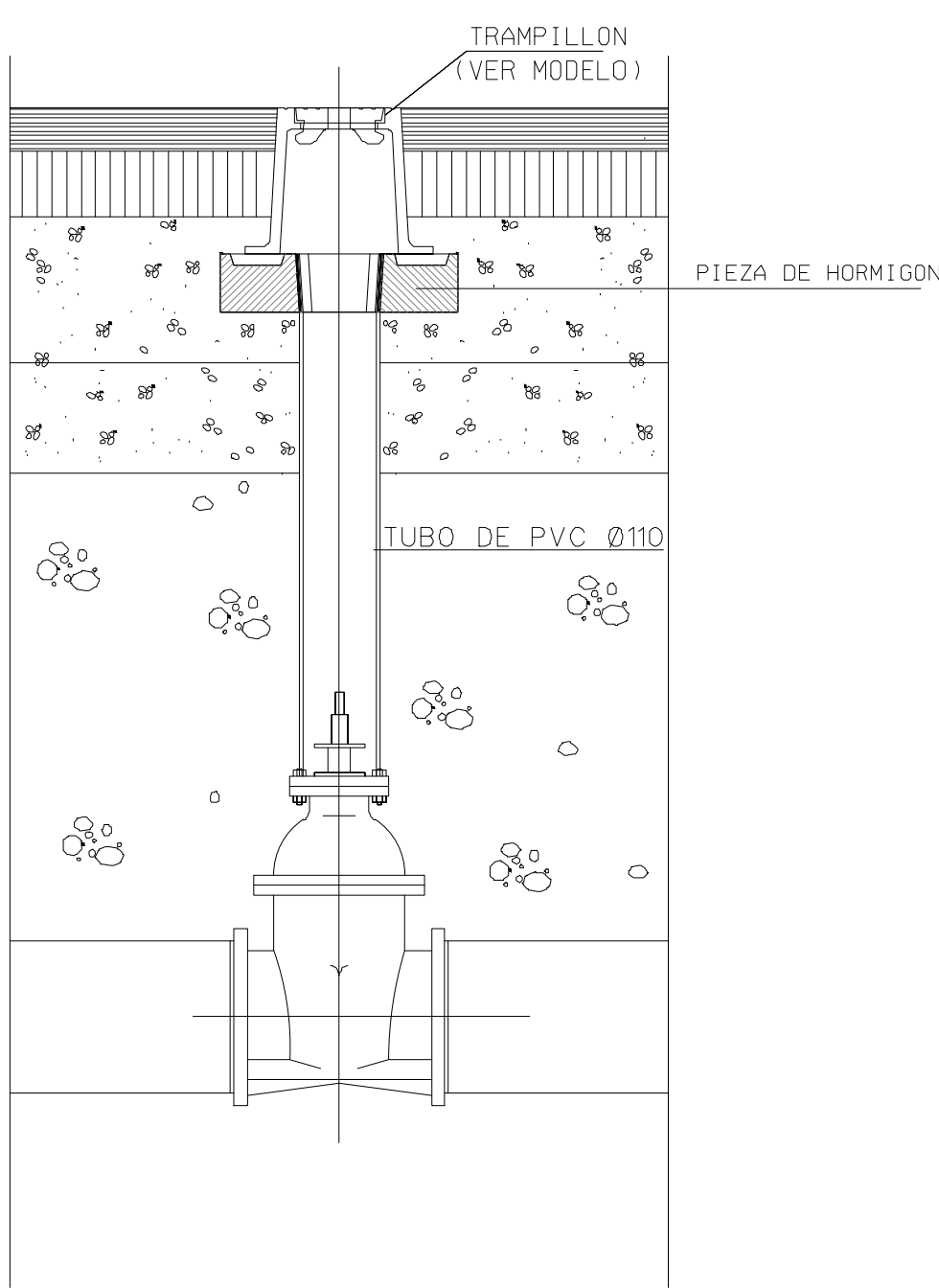

TRAMPILLON EN ACERAS H=> 1,20 m
(CON BARRON EXTENSIBLE)
E= 1:20

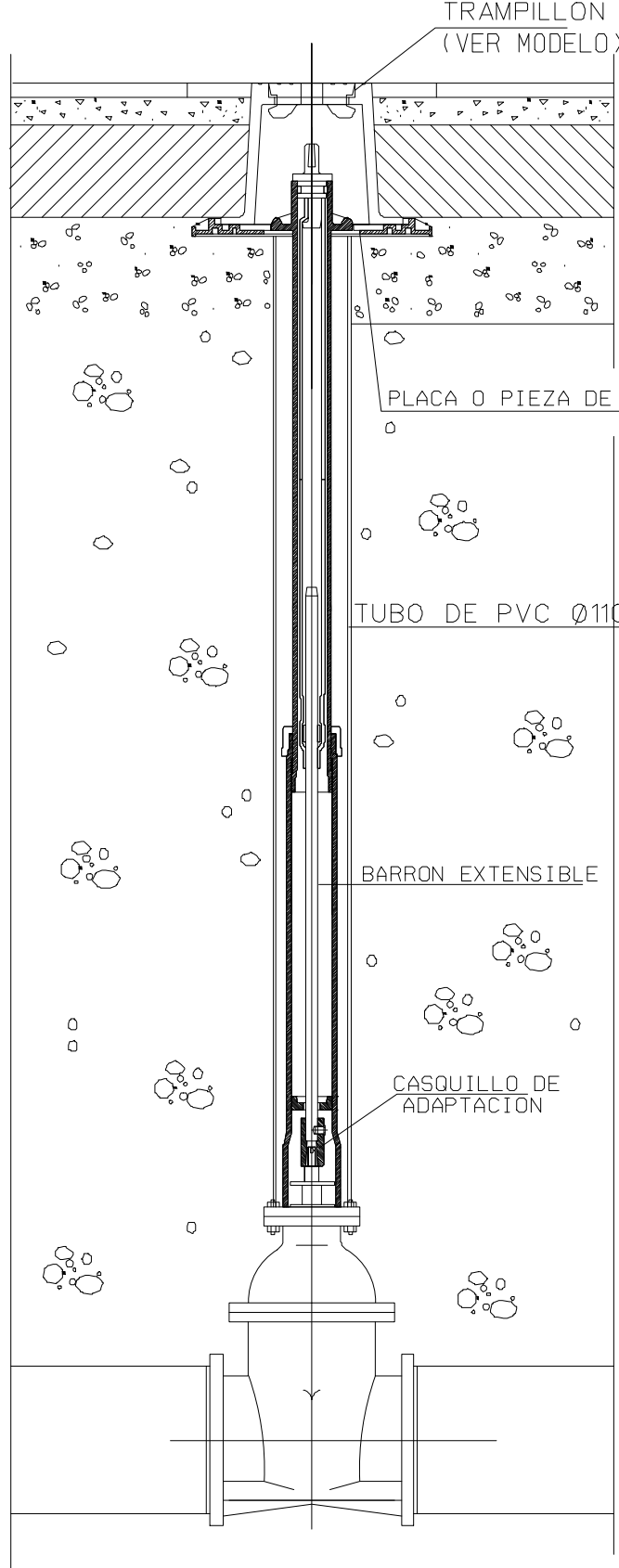

DETALLE PLACA BASE
E= 1:10

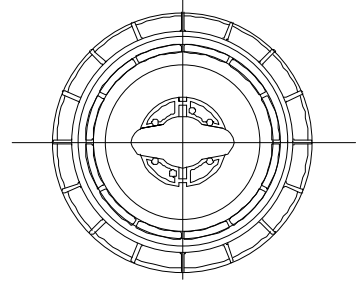

DETALLE DE PIEZA
PREFABRICADA DE
HORMIGÓN
E= 1:10

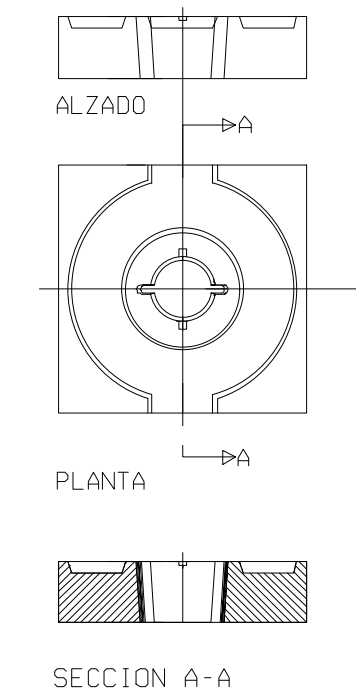

TRAMPILLON EN ACERAS H=> 1,20 m
(CON BARRON RÍGIDO)
E= 1:20

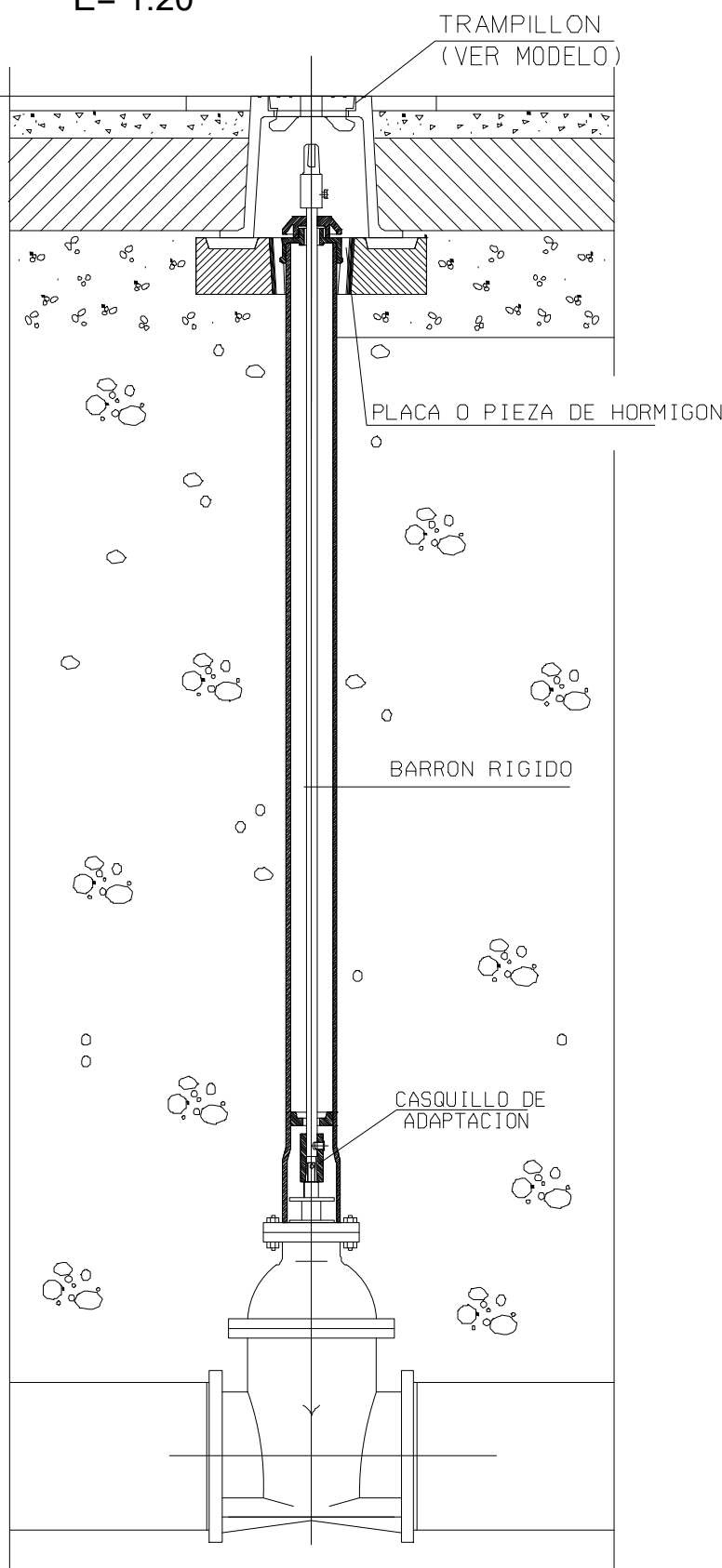

TRAMPILLON EN CALZADA H=> 1,20 m
(CON BARRON EXTENSIBLE)
E= 1:20

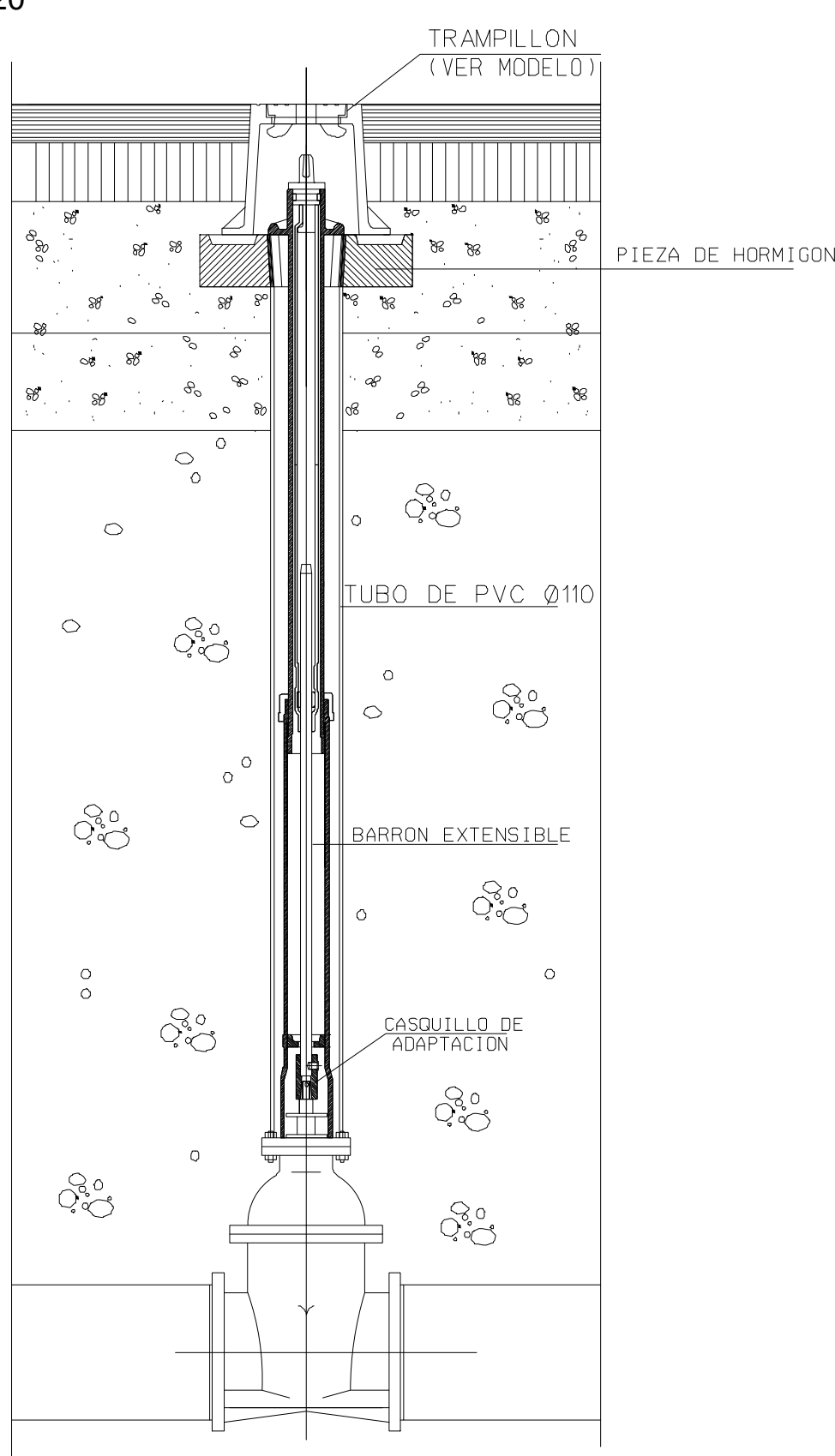

TRAMPILLON EN CALZADA H=> 1,20 m
(CON BARRON RÍGIDO)
E= 1:20

